

NEW Husqvarna Diamond Chains and Bars

NEW ELITE-GUIDE BAR FOR GREATER CUTTING DEPTH

With the launch of the new Husqvarna new Elite-Guide bar, we focus on cutting depth instead of guide bar length. The new guide bar provides a cutting depth of 450 mm which is 15 mm deeper than the previously longest guide bar in our range. It also provides improved durability, better water supply and longer service life.



NEW DIAMOND CHAINS DEVELOPED FOR MAXIMUM PERFORMANCE





We're introducing a new chain concept, built on a stronger chain chassis and a new diamond segment design for increased efficiency. The new Husqvarna diamond chains provide higher overall performance, so you can expect both greater cutting depth and longer chain life. The new range includes both Gold and Silver level chains to suit a wide variety of applications.



ELITE-CHAIN



VARI-CHAIN

PRODUCT	ELITE-CHAIN			VARI-CHAIN
	C 20	C 45	C 70	C 45
SEGMENT SHAPE				
MATERIAL				
Stone	● ● ●	●	—	—
Concrete, hard	● ● ●	● ● ●	—	●
Concrete, medium	● ●	● ● ●	●	● ● ●
Concrete, soft	● ●	● ● ●	● ●	● ●
Building brick	●	● ●	● ● ●	● ●
Abrasive building block	—	●	● ● ●	●

● ● ● = Optimal ● ● = Good ● = Acceptable — = Not recommended

ARTICLE INFORMATION

NEW RANGE

Part Number	Description	RRP Exc VAT	REPLACING	Part Number	Description
593 06 43-01	Elite-Chain C 20	£915.00	—	—	—
590 76 54-01	Elite-Chain C 45	£915.00	588 15 04-02	PRO 45	
			590 32 98-01	PXC 45	
593 06 44-01	Elite-Chain C 70	£915.00	590 33 00-01	ELC 70	
590 76 55-01	Vari-Chain C 45	£659.00	590 32 99-01	ELC 45	
			590 33 01-01	SLC 45	
591 15 28-60	Elite Guide Bar 18"	£118.28	587 78 14-02	Guide Bar 16"	

EXPIRED

			587 78 14-01	Guide Bar 12"	
			506 34 62-14	Guide Bar 14"	

Which fits what:

- ✓ Husqvarna guide bar and chain fits ICS chain power cutters.
- ✓ ICS guide bar and chain fits Husqvarna Chain power cutters.
- ✗ Husqvarna Chain does not fit today's 16" guide bar (ICS F4*) - risk of wearing the rim sprocket out.
- ✗ PRO 45 Chain (ICS F4*) does not fit Husqvarna 18" guide bar - risk of wearing the rim out before the chain.

NEW Husqvarna Diamond Chains and Bars

Husqvarna new diamond chains and bars are not interchangeable with previous models of bars and chains. When ordering a new chain or a new bar you will also need to order both the new bar and chain plus depending on the chainsaw model and age a spline-way and clutch drum may also need to be purchased.

Please find below information needed when purchasing new diamond chains and bars:

K950 Chain, K960 Chain, K970 Chain and K970II Chain with serial number 201601000001 or before will require the following:

Quantity	Part Number	Description
1	depending on model	18" Chain (bond of your choice) delivered with rim sprocket
1	591 15 28-60	18" Guide bar
1	587 26 99-01	Spline-way
1	588 67 97-01	Clutch Drum

K 970 III Chain and K 6500 Chain will require the following:

Quantity	Part Number	Description
1	depending on model	18" Chain (bond of your choice) delivered with rim sprocket
1	591 15 28-60	18" Guide bar



18" Chain with rim sprocket



18" Guide bar



Spline-way

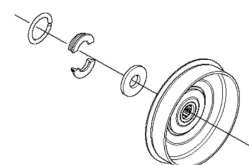

Clutch Drum